

1 What is the size of angle D?

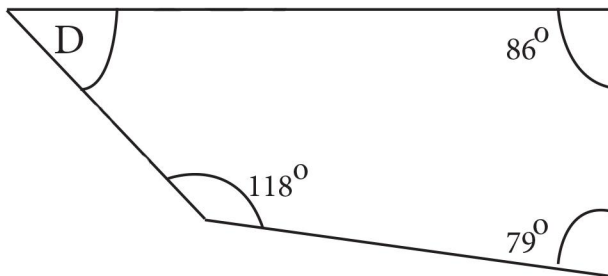

2 A large taxi can carry six passengers. Fifty-three people plan to travel to a concert at the same time. How many taxis should be ordered?

taxis



3 Use the words in the panel below to describe angles of...

127 degrees

217 degrees

90 degrees

88 degrees

Right Acute Reflex Obtuse

- 4 There were 4800 supporters at an England versus Scotland basketball match. 17% of the supporters were supporting Scotland.

How many Scotland supporters were there?

supporters

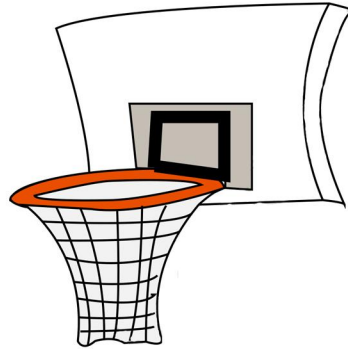

- 5 $2.8 \times 3.87 =$

- 6 The teacher has a 3.9 litre bottle of water. How many glasses each holding 300 millilitres can you fill from it?

glasses

- 7** A bus leaves the city centre bus station every twelve minutes. The first bus leaves the station at 4:30am.

How many buses will have left the station by 7:30am?

buses



- 8** Zara saved 26 coins in her money box. Her money box contains at least 3 of each of the following coins:

5p 10p 20p 50p £1 £2

What is the greatest amount of money that Zara could have in her money box?

£

A plan of Liverpool Primary School's staff room is shown in the diagram below. The key tells you where the kitchen is. The kitchen area has tiles on the floor. The rest of the staff room has carpet on the floor.

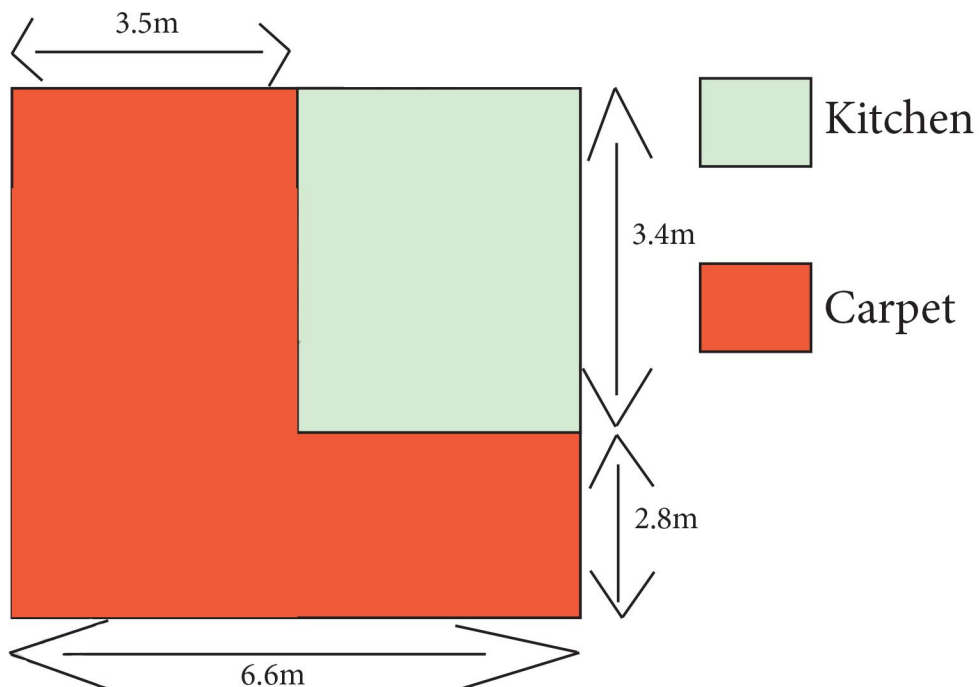

- 9 Calculate the area of kitchen tiles on the floor.

- 10 Calculate the area of carpet on the floor.